

TRAVEL **90° ±5° AT BOTH ENDS**
 RATIO **309.1:1**
 TURNS TO CLOSE **77.3**
 MECHANICAL ADVANTAGE ... **99 ±10%**

MAXIMUM OUTPUT TORQUE (1000 CYCLES)..... **13000 Nm**
 MAXIMUM OUTPUT TORQUE (2500 CYCLES)..... **10800 Nm**
 MAXIMUM INPUT TORQUE (1000 CYCLES)..... **131 Nm**
 MAXIMUM INPUT TORQUE (2500 CYCLES)..... **109 Nm**

MOUNTING HOLE DETAIL (BSENISO 5211:2001)

APPROXIMATE WEIGHT **87 kg**

PREFERRED **F30 (8 x M20 on 298 PCD)**
 MAXIMUM **F30 (8 x M20 on 298 PCD)**
 MINIMUM **F20 (8 x M12 on 197 PCD)**



OPPERMAN MASTERGEAR

Hambridge Lane, Newbury, Berkshire, RG14 5TS. ENGLAND
 Tel: 01635 811500 Fax: 01635 811501 E-Mail: sales@opperman-mastergear.co.uk

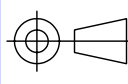

To BS308

DIMENSIONS IN
 MM [INCHES]

DATE	23Aug05
DRAWN	BJH
CHECKED	MAB
SCALE	1:6

This drawing/design is the property of OPPERMAN MASTERGEAR Ltd. © and must not be used or copied without their specific written consent. Specifications may change without prior notification

DRG No. **ME-15371**

REV. **B**