

OUTPUT KEYWAY DETAILS
(SHOWN IN OPEN POSITION)

GENERAL INFORMATION

TRAVEL.....	90° ±5° AT BOTH ENDS	MAX. OUTPUT TORQUE (1000 CYCLES)...	1200Nm
RATIO.....	42:1	MAX. OUTPUT TORQUE (2000 CYCLES)...	1000Nm
TURNS TO CLOSE.....	10.5	MAX. INPUT TORQUE (1000 CYCLES)....	106Nm
MECH. ADVANTAGE.....	11.3 ±10%	MAX. INPUT TORQUE (2000 CYCLES)....	88Nm

MOUNTING HOLE DETAIL: PREFERRED.....	F12 (4 × M12 ON 125 PCD ×13 DEEP)
(MSS SP-101) MAXIMUM.....	F16 (4 × M20 ON 165 PCD ×17 DEEP)
MINIMUM.....	F10 (4 × M10 ON 102 PCD ×13 DEEP)

APPROXIMATE WEIGHT..... 5 kg



MASTERGEAR GMBH

Siemensstrasse 16 D-61267 Neu-Anspach

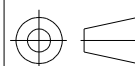

DIMENSIONS
IN
mm

SCALE

1:3

DRAWING
No.

9807