

OUTPUT KEYWAY DETAILS
(SHOWN IN OPEN POSITION)

GENERAL INFORMATION

TRAVEL.....90° ±5° AT BOTH ENDS	MAX. OUTPUT TORQUE (1000 CYCLES)...	600Nm
RATIO.....40:1	MAX. OUTPUT TORQUE (2000 CYCLES)...	500Nm
TURNS TO CLOSE.....10	MAX. INPUT TORQUE (1000 CYCLES).....	54Nm
MECH. ADVANTAGE.....11 ±10%	MAX. INPUT TORQUE (2000 CYCLES).....	45Nm

MOUNTING HOLE DETAIL: PREFERRED.... F10 (4 × M10 ON 102 PCD ×13 DEEP)
 MAXIMUM..... F12 (4 × M12 ON 125 PCD ×13 DEEP)
 MINIMUM..... F07 (4 × M8 ON 70 PCD ×13 DEEP)

APPROXIMATE WEIGHT.....2.3 kg



MASTERGEAR GMBH

Siemensstrasse 16 D-61267 Neu-Anspach

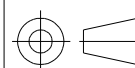

DIMENSIONS
IN
MM

SCALE

1:2

DRAWING
No.

9804